



**LEENDERS**

SINCE 1979

# FÄLTOVN

# Do It Yourself

BUILD INSTRUCTION EN



## Points of attentions for assembling Fältovn Do It Yourself (DIY)

- Tools:** Allen key 4 (included) + wrench 10
- Bolts and nuts:** 36x stainless steel allen bolts, 6x lock nuts, 3x brass rings (all included)
- Note:** Components can be sharp. Wearing safety gloves can prevent injury. It only makes it a little difficult to pick your nose.
- Tip 1:** Do not immediately tighten all the bolts, it makes it easier to assemble the rest. When the Fältovn is ready, you can tighten all the bolts (unless otherwise stated in this instruction).
- Tip 2:** While using the Fältovn you can remove the bolts, which are used to tighten the side rack<sup>15</sup>, and clean them from time to time. This way you prevent them from becoming too difficult to come loose.
- Super quick instruction:** align the 3 √-signs and the rest is logical.
- Super convenient instruction:** on [leenders.nl/service](http://leenders.nl/service) you can find an instruction video.

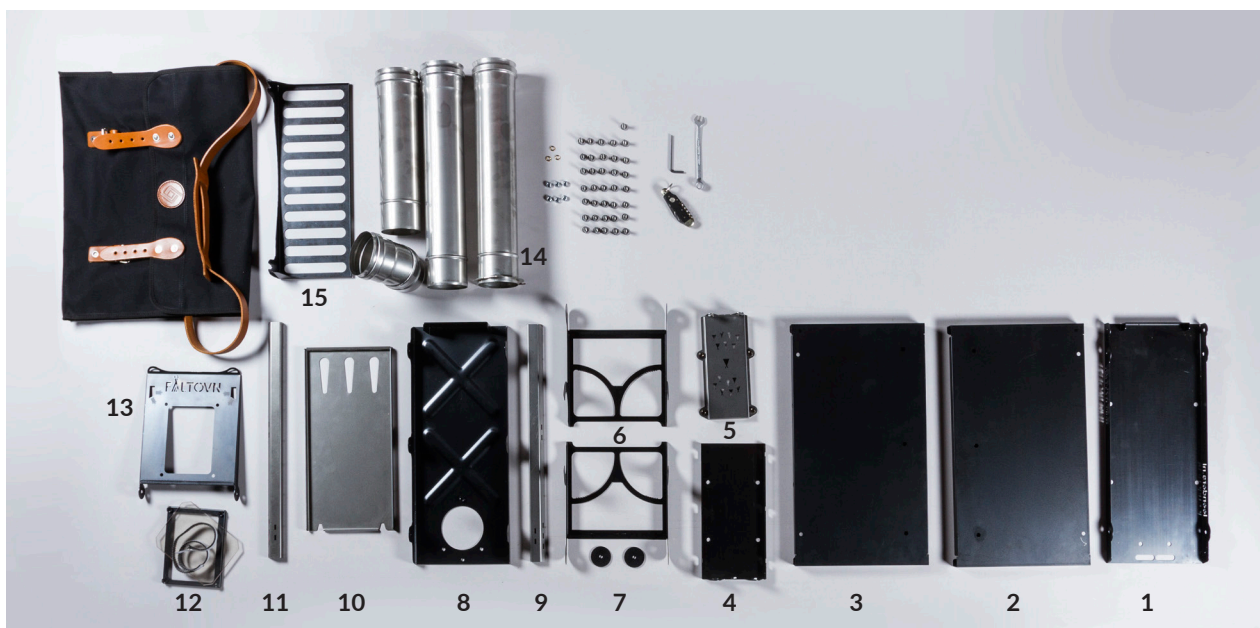



## Slightly less fast instruction

1. Mount the bottom plate<sup>1</sup> to the left side plate<sup>2</sup> (2x bolt in the bottom).  
Align the √-sign.
2. Mount the right side<sup>3</sup> plate to the bottom plate (2x bolt in bottom).
3. Mount the back plate. First turn bolts (6x) in the sidewall, do not tighten.  
Then slide the back plate in and tighten the bolts (6x).
4. Mount the air tray into the back plate (4x bolt).  
Also mount the air tray onto the bottom plate (2x bolt)
5. Mount the front legs (2x bolt + 2x lock nuts).  
Do not tighten the lock nuts too tight, the legs have to be able to move.
6. Mount the back legs (2x brass rings + 2x bolts+ 2x lock nuts). Align the √-sign.  
Do not tighten the lock nuts too tight, the legs have to be able to move.
7. Place the lid<sup>8</sup> and the first airshaft<sup>9</sup>.  
The air holes to the back and facing downwards.
8. Install the airshaft on the lid and the side plate (3x bolt)
9. Place the heat shield<sup>10</sup>.  
Openings (3x) facing to the front and raised edge pointing up.
10. Place the second airshaft<sup>11</sup>. Air openings at the back plate and pointing downwards.
11. Heat shield must rest on both airshafts, and have to be able to move freely.
12. Mount the second airshaft to the lid and the side plate (3x bolt). This can be quite difficult sometimes. It tends to help to keep the airshaft at a slight distance from the sidewall. This way the bolt will easier find the hole and attaches better to the screw thread.
13. Mount the lid on the top and to the rear back (3x bolt + 2x brass rings).  
Use the two rings for the two outer bolts.
14. Tape the flat band over the edge of the glass<sup>12</sup>.
15. Mount the glass with frame on the inside of the door<sup>13</sup> (4x bolt)
16. Mount the door (2x bolt + 2x lock nuts).  
Do not tighten the lock nuts too tight, the doors have to be able to move.
17. Fit the remaining bolts and rings in the only remaining, and for that destined, holes.
18. Quickly go outside, put the pipe<sup>14</sup> on top and start the fire!



Mount the bottom plate<sup>1</sup> to the left side plate<sup>2</sup> (2x bolt in the bottom).  
Align the √-sign.

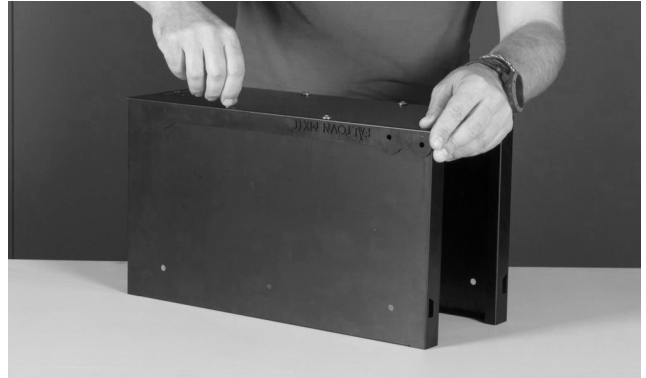

Mount the right side<sup>3</sup> plate to the bottom plate (2x bolt in bottom).



Mount the back plate<sup>4</sup>. First turn bolts (6x) in the sidewall, do not tighten.  
Then slide the back plate in and tighten the bolts (6x).



Mount the air tray<sup>5</sup> into the back plate (4x bolt).



Also mount the air tray onto the bottom plate (2x bolt).



Mount the front legs<sup>6</sup> (2x bolt + 2x lock nuts).  
Do not tighten the lock nuts too tight, the legs have to be able to move.



Mount the back legs<sup>7</sup> (2x brass rings + 2x bolts + 2x lock nuts). Align the √-sign.  
Do not tighten the lock nuts too tight, the legs have to be able to move.



Place the lid<sup>8</sup> and the first airshaft<sup>9</sup>.  
The air holes to the back and facing downwards.



Install the airshaft on the lid and the side plate (3x bolt)

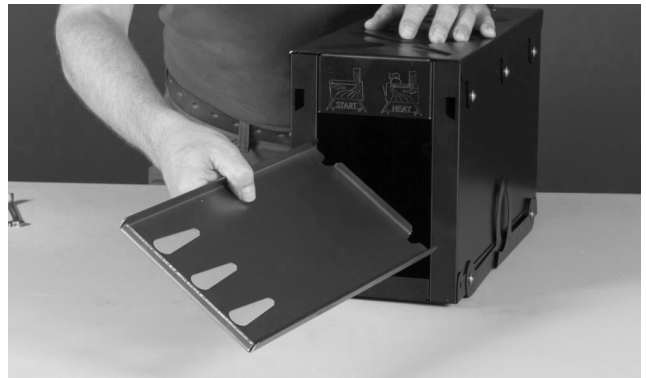

Place the heat shield<sup>10</sup>.  
Openings (3x) facing to the front and raised edge pointing up.



Place the second airshaft<sup>11</sup>. Air openings at the back plate and pointing downwards.  
Heat shield must rest on both airshafts, and have to be able to move freely.

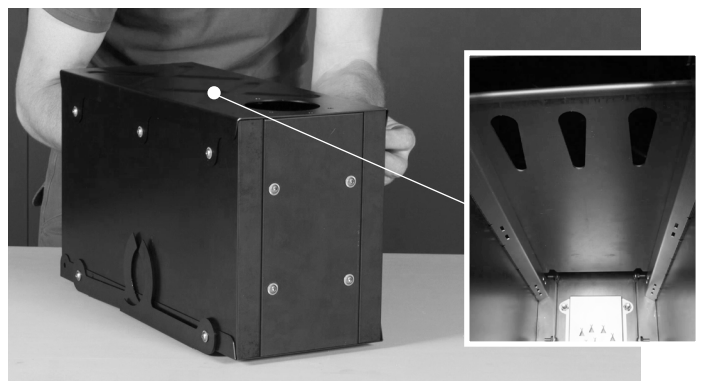

Mount the second airshaft to the lid and the side plate (3x bolt). This can be quite difficult sometimes. It tends to help to keep the airshaft at a slight distance from the sidewall. This way the bolt will easier find the hole and attaches better to the screw thread.



Mount the lid on the top and to the rear back (3x bolt + 2x brass rings).  
Use the two rings for the two outer bolts.



Tape the flat band over the edge of the glass<sup>12</sup>.

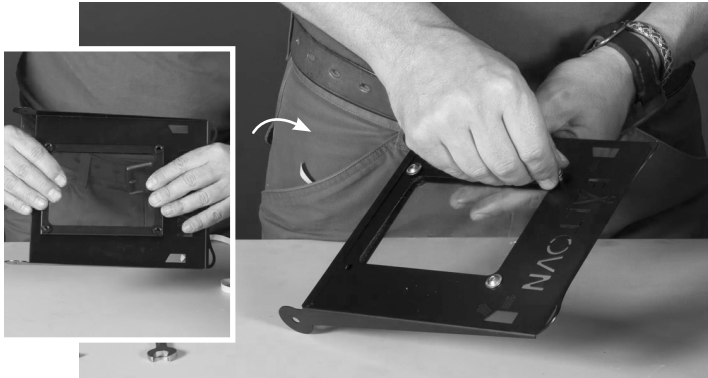

Mount the glass with frame on the inside of the door<sup>13</sup> (4x bolt)

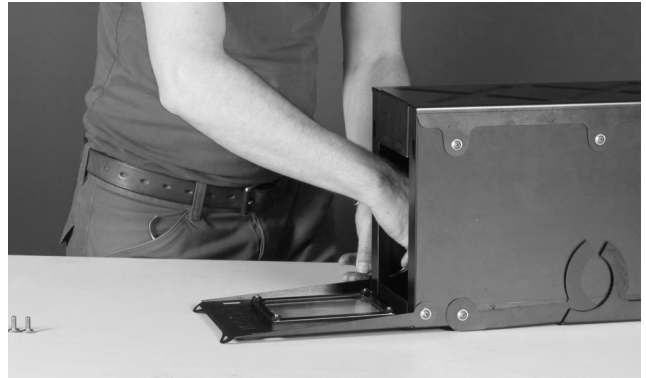

Mount the door<sup>13</sup> (2x bolt + 2x lock nuts).  
Do not tighten the lock nuts too tight, the door has to be able to move.



Fit the remaining bolts and rings in the only remaining, and for that destined, holes.



Quickly go outside, put the pipe<sup>14</sup> on top and start the fire!